



**WHALLON**  
MACHINERY, INC.

MATERIAL HANDLING  
EQUIPMENT

**WHALLON MACHINERY, INC.**

P.O. Box 429 • 205 North Chicago Street

Royal Center, Indiana 46978

Ph: 574-643-9561 • Fax 574-643-9218

[www.whallon.com](http://www.whallon.com)

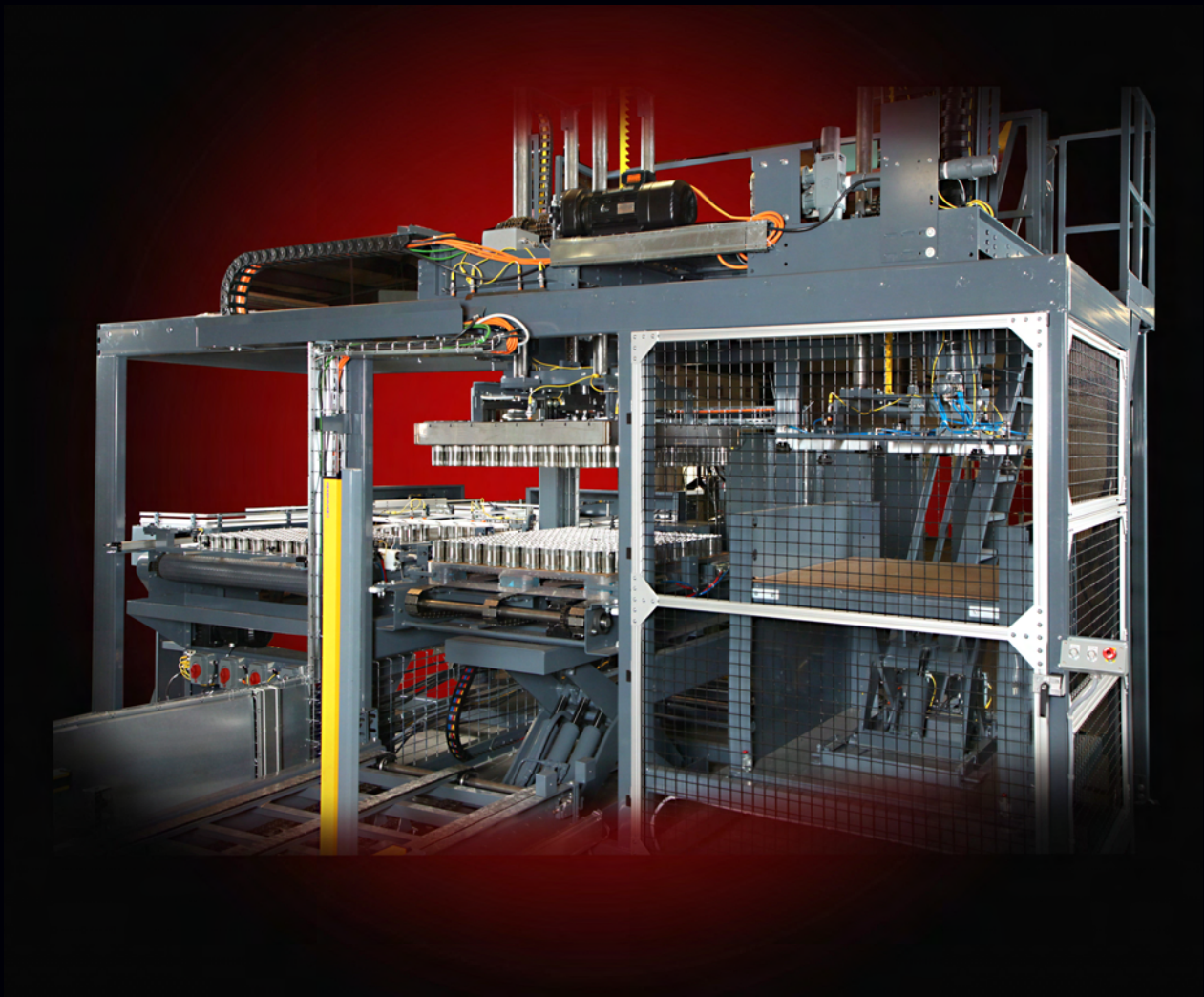

## **PD180 SERIES**

Shuttle Palletizing and Depalletizing

Certain safety features removed for photographic purposes



**WHALLON**  
**MACHINERY, INC.**

MATERIAL HANDLING  
EQUIPMENT

**WHALLON MACHINERY, INC.**

P.O. Box 429 • 205 North Chicago Street

Royal Center, Indiana 46978

Ph: 574-643-9561 • Fax 574-643-9218

[www.whallon.com](http://www.whallon.com)

## PD180 Shuttle Palletizer/Depalletizer

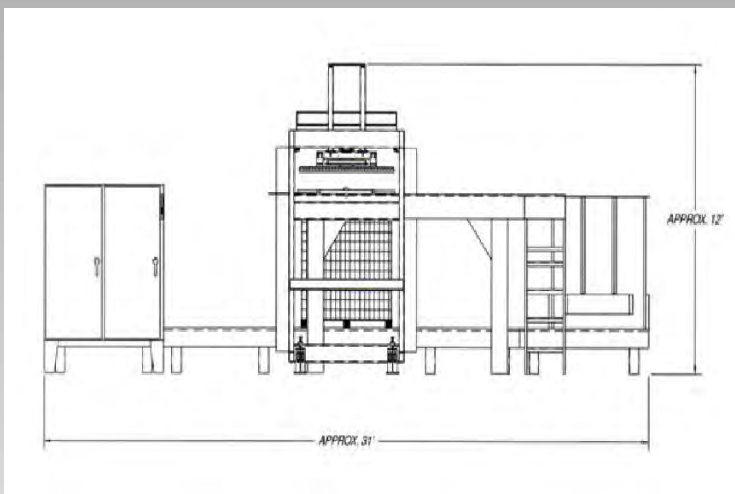
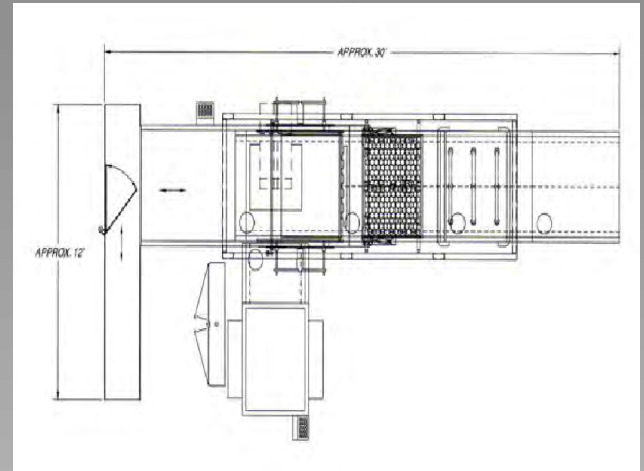
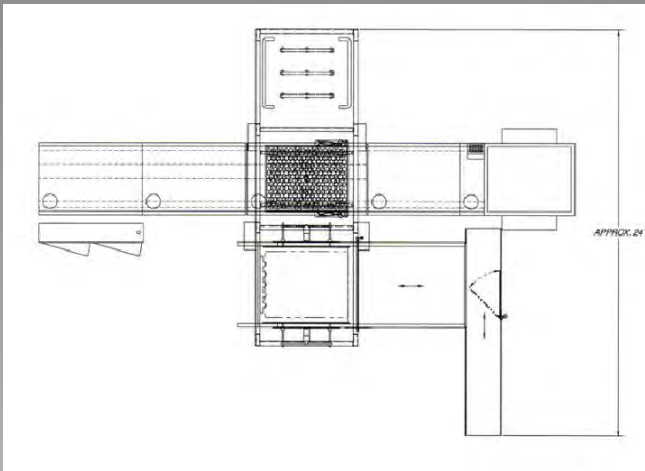

The Shuttle Palletizer/Depalletizer shares the tradition of all Whallon equipment by providing a quality product with exceptional service support for the life of the system.

Once again, Whallon Machinery has met customer requirements by providing a high speed, consistently dependable unit.

The Whallon Shuttle Palletizer/Depalletizer is a flexible unit that can be placed into various layouts. The numerous combinations of single filers, accumulation tables, and pallet conveyors enable the system to operate under space restrictions or with existing lines and equipment. The unit is versatile enough to handle cans ranging in size from 201 to 701 diameters with quick and easy changeover times. The system can be manufactured with standard components or the customer can specify motors, valve assemblies, sensors, and programmable logic controller

