

Shuttle Palletizer/Depalletizer

To meet the changing needs of today's market, Whallon Machinery, Inc. has developed a shuttle style palletizer/depalletizer. In the past, linear and lateral movements were controlled using a hydraulic pump, cylinders, and valves. The shuttle's hydraulic movements have now been replaced with programmable AC frequency drives that can handle four cycles per minute. This unit can be designed as a semi-automatic or fully automatic palletizer/depalletizer. In the palletize mode, the pallet lift raises an empty pallet to a set height. The magnet head lifts a pattern of cans off of the

accumulation table, shuttles the cans over the pallet, and lowers the layer to the pallet. The pallet lift then lowers to reset at the optimum height. This process is repeated until a full pallet of product is stacked. In the depalletize mode, single layers of cans are lifted off the pallet and placed on the table which transfers the cans to the desired location. In this mode, the pallet lift raises to the optimal layer height until the pallet is empty. Fully automatic units are equipped with auto pallet handling and auto slip-sheet placement or removal.

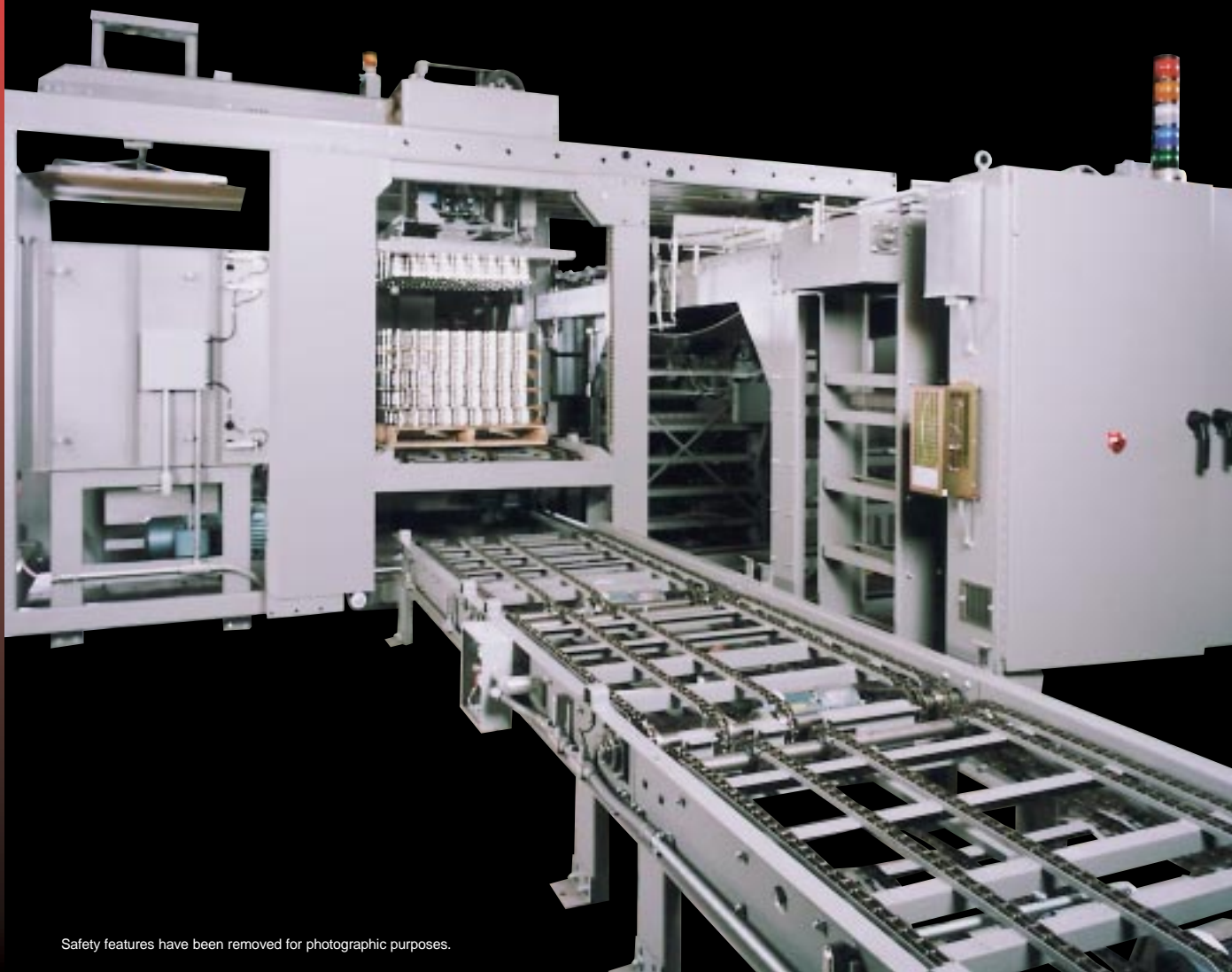

Shuttle Palletizer/Depalletizer

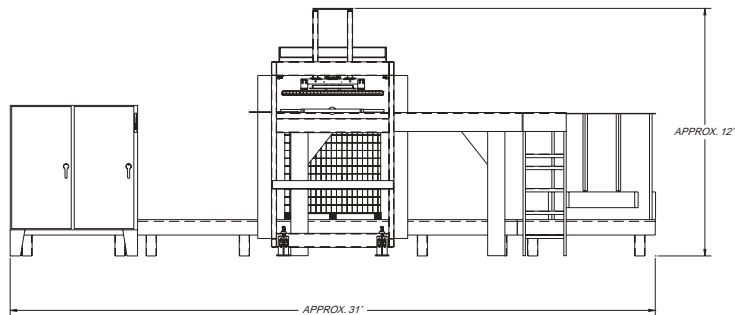
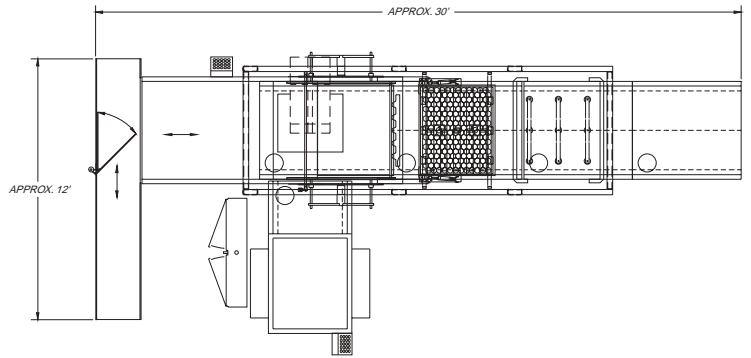
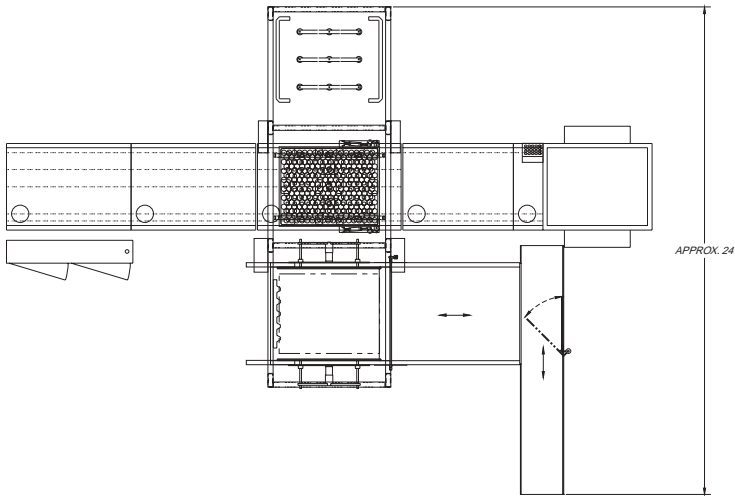

The shuttle palletizer/depalletizer shares the tradition of all Whallon equipment by providing a quality product with exceptional service support for the life of the system. Once again, Whallon Machinery has met customer requirements by producing a high speed, consistently dependable unit.

The Whallon shuttle palletizer/depalletizer is a flexible unit that can be placed into various layouts. The numerous combinations of single filers, accumulation tables, and pallet conveyors enable the system to operate under space restrictions or with existing lines and equipment. The unit is versatile enough to handle cans ranging in size from 201 to 701 diameters with quick and easy changeover times. The system can be manufactured with standard components or the customer can specify motors, valve assemblies, sensors, and programmable logic controller.



Safety features have been removed for photographic purposes.